

BALANCING VALVE

PN 16

DN 40... DN 300

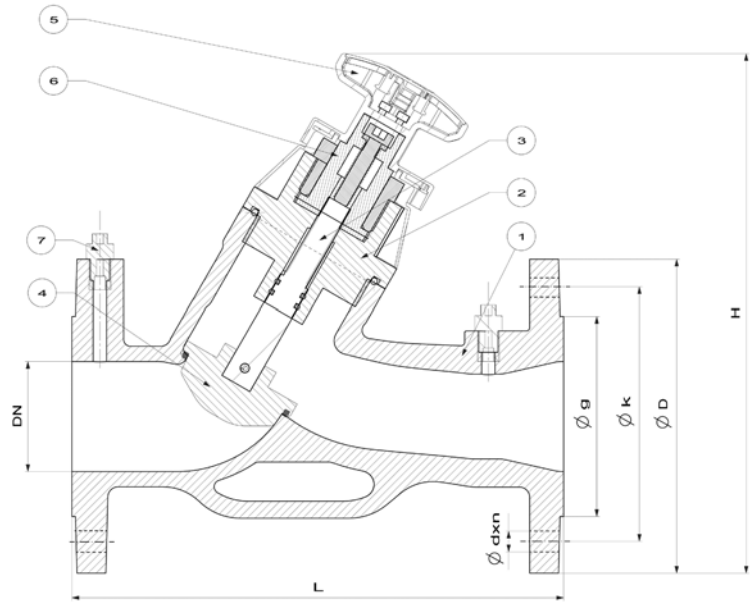
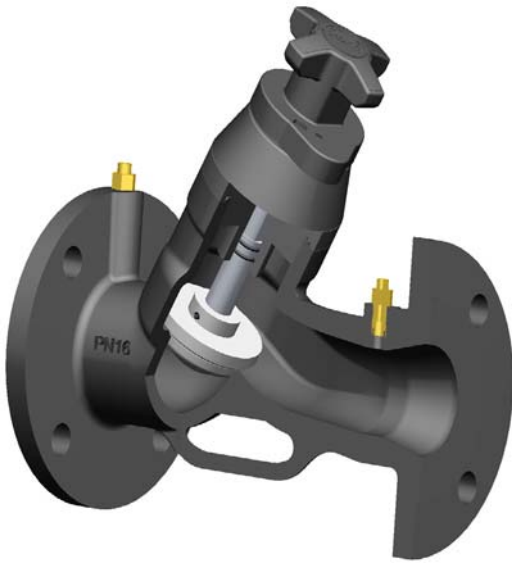

| MATERIALS | | |
|-----------|---------------------|-------------------------|
| NO | PART NAME | MATERIAL |
| 1 | BODY | EN-JL 1040 / EN-JS 1020 |
| 2 | BONNET | EN-JL 1040 / EN-JS 1020 |
| 3 | STEM | STAINLESS STEEL |
| 4 | DISC | STAINLESS STEEL+PTFE |
| 5 | HANDWHEEL | PA GF30 |
| 6 | YOKE NUT | BRASS (CuZn40Pb2) |
| 7 | PRESSURE TEST POINT | BRASS (CuZn40Pb2) |

| DESIGN | Balancing Valve |
|-------------------------|-------------------------------|
| FLANGE AND THEIR JOINTS | TS ISO 7005-1 BS EN 1092-2 |
| FACE TO FACE DIMENSIONS | TS EN 558-1 SERIES 1 |

| BALANCING VALVE | | | | | | | | | | | | |
|-------------------|-------|----------|-----|-----|-----|-----|-----|-----|-----|-----|-----|-----|
| Nominal Pressure | PN 16 | | | | | | | | | | | |
| Nominal Diameter | DN | 40 | 50 | 65 | 80 | 100 | 125 | 150 | 200 | 250 | 300 | |
| Valve Dimensions | L | 200 | 230 | 290 | 310 | 350 | 400 | 480 | 600 | 730 | 850 | |
| | H | 180 | 190 | 215 | 225 | 360 | 375 | 393 | 435 | 460 | 490 | |
| Flange Dimensions | PN 16 | D | 150 | 165 | 185 | 200 | 220 | 250 | 285 | 340 | 405 | 460 |
| | | k | 110 | 125 | 145 | 160 | 180 | 210 | 240 | 295 | 355 | 410 |
| | | g | 84 | 99 | 118 | 132 | 156 | 184 | 211 | 266 | 319 | 370 |
| | | b | 18 | 20 | | 22 | 24 | 26 | | 30 | 32 | |
| | | d | 19 | | | 23 | | | 28 | | | |
| | | Hole Qty | n | 4 | | | 8 | | | 12 | | |

| TEMPERATURE / PRESSURE | | APPLICATIONS |
|------------------------|-----------------|---|
| °C | -10 + 120 | Maintaining a hydronic balance between the various system circuits in the pipings of hot water central heating systems and cooling systems. |
| PN | 16 | |

"Due to continuous development of our products, we reserve the right to modify our product design or construction without prior notice."



**PRODUCED IN TURKEY,
COMPETING AROUND
THE WORLD!**



**DUYAR STATIC
BALANCING VALVE**



**VISION
2015 45+5**

www.duyarvalve.com

100% LOCAL PRODUCTION

Design: Y Type Glob Valve

Flange connection dimensions
TS-ISO 7005-2

Face to face dimensions
EN 558, Serie 1

Material: EN-JL 1040

Dimensions: DN 40-300

Applications: Flow rate adjustment
and balancing in HVAC system

Working Temperature: -10.....+120

Nominal Pressure: 16 bars



DESIGN FEATURE

Computational Fluid Dynamics (CFD) were used to obtain the perfect shape for applications.



PROTOTYPE TESTS

Tested on real installations.



ADJUSTMENT SPECIFICATION

Handwheel indicator with 20 positions per cycle.



LEAKPROOFING SYSTEM

The solid PTFE-teflon on the disc guarantees %100 leak-tightness.



CARRIAGE SYSTEM

With the handles on the product carriage simplicity is provided.

→ KV %

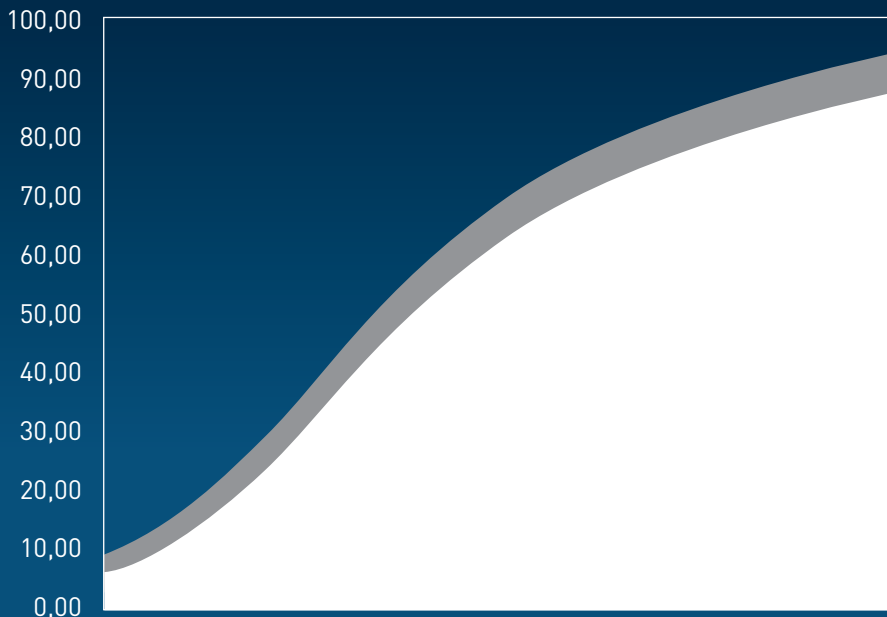

PERFECT RESULT

Table shows the curve tendency with an increase until 50 % of the stroke level and with the decrease above 50 % of stroke level. Thus adjustment sensibility is perfectly possible for cycles that exceed 50%.

→ STROKE